



TILTIX Inclinometer

ACS-080-2-AC00-HK3-PQ

General Specifications

| | |
|-------------------|--|
| Application | 2-Axes Position Monitoring and Leveling |
| Measurement Range | $\pm 80^\circ$ |
| Absolute Accuracy | $\pm 0.10^\circ$ (within $\pm 60^\circ$ range) |
| Resolution | 0.01° |

Electrical Specifications

| | |
|-----------------------------|-------------------|
| Supply Voltage | 10 - 30 VDC |
| Power Consumption (no load) | ≤ 0.7 W |
| EMC: Emitted Interference | DIN EN 61000-6-4 |
| EMC: Noise Immunity | DIN EN 61000-6-2 |
| Reverse Polarity Protection | Yes |
| Short Circuit Protection | Yes |
| MTTF | 400 years @ 40 °C |

Environmental Specifications

| | |
|-----------------------|---|
| Operating Temperature | -40 °C (-40 °F) - +85 °C (+185 °F) |
| Storage Temperature | -40 °C (-40 °F) - +85 °C (+185 °F) |
| Temperature Gradient | 0.004°/ K |
| Protection Class | IP68/IP69K |
| Shock Resistance | ≤ 100 g (half sine 6 ms, EN 60068-2-27) |
| Vibration Resistance | 1.5 mm (10 Hz - 58 Hz) & ≤ 20 g (58 Hz to 2000 Hz) |

Mechanical Specifications

| | |
|------------------|-----------------|
| Housing Material | Zinc |
| Potting Material | None |
| Weight | 220 g (0.49 lb) |

Interface

| | |
|---------------|--|
| Interface | Analog Current 4 - 20 mA |
| Settling Time | min 30 ms; default 200 ms (dependent on filter settings) |
| Output Type | Current 4 - 20 mA |

Data Sheet

Printed at 10-09-2023 22:09

| | |
|---------------------|---|
| Max Load Resistance | 270 Ω @ 10 V DC (500 Ω @ 15 V DC) |
| Linearity | $\pm 0.02\%$ |

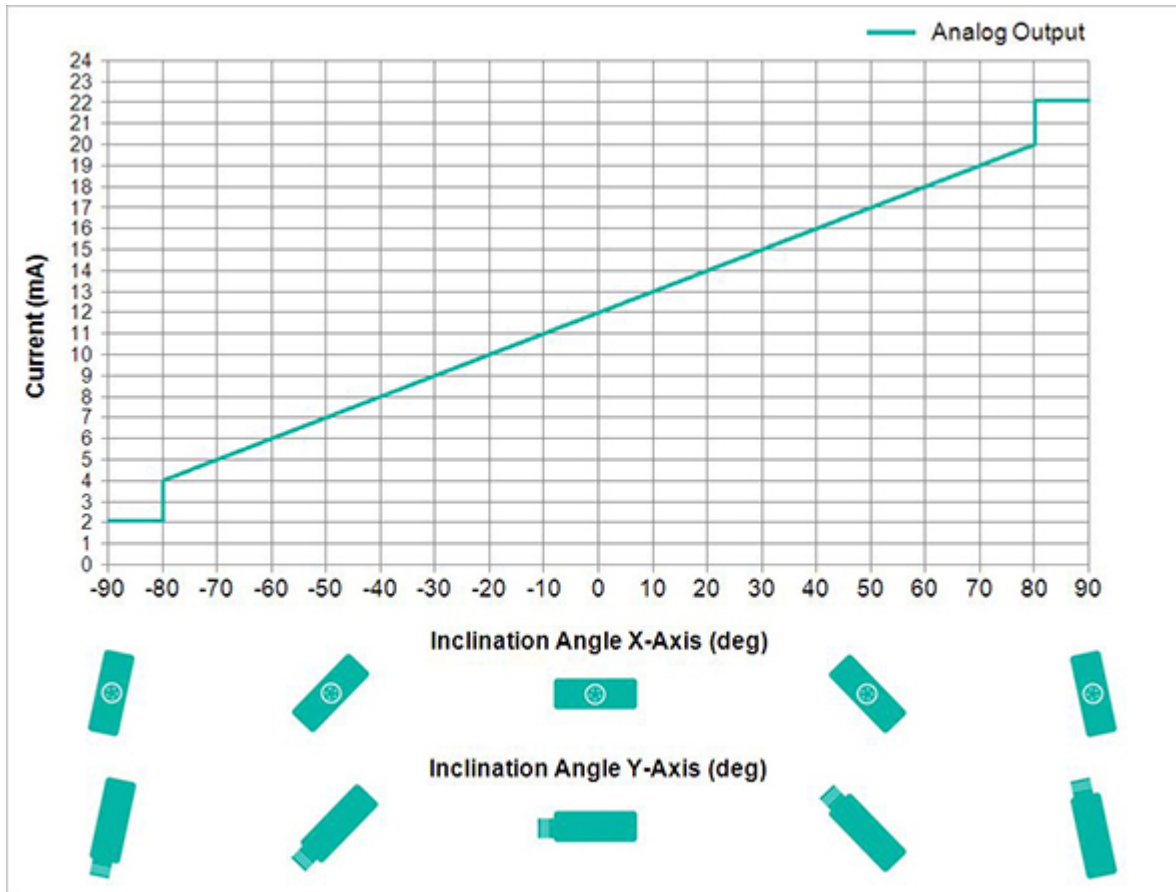

Electrical Connection

| | |
|-----------------|---------------------------|
| Connection Type | Connector M12 (8 pin) |
| Connector | M12, Male, 8 pin, a coded |

Product Life Cycle

| | |
|--------------------|-----|
| Product Life Cycle | New |
|--------------------|-----|

Certification

| | |
|----------|----|
| Approval | CE |
|----------|----|

Connection Plan

| SIGNAL | PIN NUMBER |
|--------------|------------|
| Power Supply | 1 |



| | |
|------------------------|---|
| GND | 4 |
| X-Axis, Current Output | 5 |
| Y-Axis, Current Output | 7 |
| Set1 | 6 |
| Do Not Connect | 8 |
| Do Not Connect | 2 |
| Do Not Connect | 3 |

Dimensional Drawing

[2D Drawing](#)

Accessories

Connectors & Cables

M12, 5pin A-Coded, Male

5m PUR Cable, 5pin, A-Coded, f

2m PUR Cable, 5pin, A-Coded, f

Angled M12, 5pin A-Coded, Female

2m PUR Cable, 5pin, A-Coded, m

10m PUR Cable, 5pin, A-Coded, f

5m PUR Cable, 5pin, A-Coded, m

POS M12 5pin-A Female+5m PUR Cable

10m PUR Cable, 5pin, A-Coded, m

POS M12 5pin-A Female+2m PUR Cable

POS M12 5pin-A Female+10m PUR Cable

M12, 5pin A-Coded, Female

More

Displays

AP22-D0 Analog Display (4 dig. o/p)

DiMod-A Analog Display

Got questions? Need an individual solution? We are here to help!



Contact Us

Data Sheet

Printed at 10-09-2023 22:09



All dimension in [inch] mm. This drawing and the information contained is for general presentation purposes only. Please refer to the "Download" section for detailed technical drawings. © FRABA B.V., All rights reserved. We do not assume responsibility for technical inaccuracies or omissions. Specifications are subject to change without notice.



Accessories

10043747 - DiMod-A Analog Display



General Data

| | |
|-------|---|
| Intro | 8 Digit display in DIN-enclosure 96 X 48 mm, 0/4-20mA / 0-10V Input , All inputs and outputs optically isolated, Serial port for PC based programming |
|-------|---|

Electrical Data

| | |
|------------------------|-----------|
| Supply Voltage | 8 -26V DC |
| External Sensor Supply | +Vs |

General Data

| | |
|-----------------------|---|
| Max. Counting Range | -9999...+99999 |
| Input Type | 0-20mA / 4-20mA / 0-10V |
| Digital Outputs 1...4 | 2 Relay Outputs (Programmable) |
| Serial Ports | RS485 (Modbus RTU) |
| Display | 6 Digit, 7 Segment LED, 14.4mm Digit Height |

Mechanical Data

| | |
|-----------------------|-----------------------------|
| Operating Temperature | 0°C to 50°C / 32°F to 122°F |
| Weight | 250 g |
| Sealing | Front: IP54 / Rear: IP20 |
| Panel Cut-Out | 92 x 43 mm |

Data Sheet

Printed at 10-09-2023 22:09

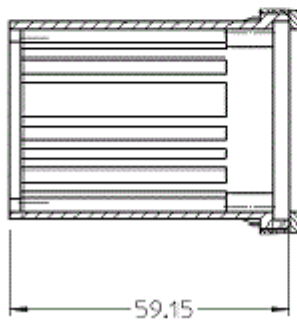
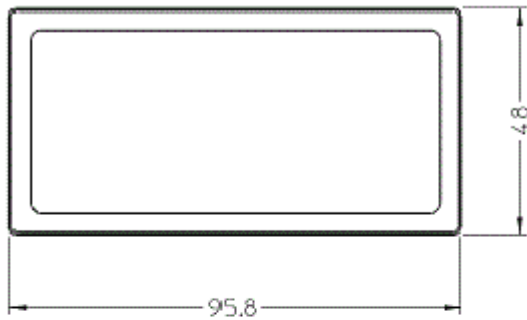

Contact



Contact Us

All dimension in [inch] mm. This drawing and the information contained is for general presentation purposes only. Please refer to the "Download" section for detailed technical drawings. © FRABA B.V., All rights reserved. We do not assume responsibility for technical inaccuracies or omissions. Specifications are subject to change without notice.